

DETAILS OF SEMI U/G WATER RESERVOIR
CAP. = 4800 LTRS. SCALE= 1:50

DETAILS OF SEPTIC TANK
SCALE= 1:50
30 USERS

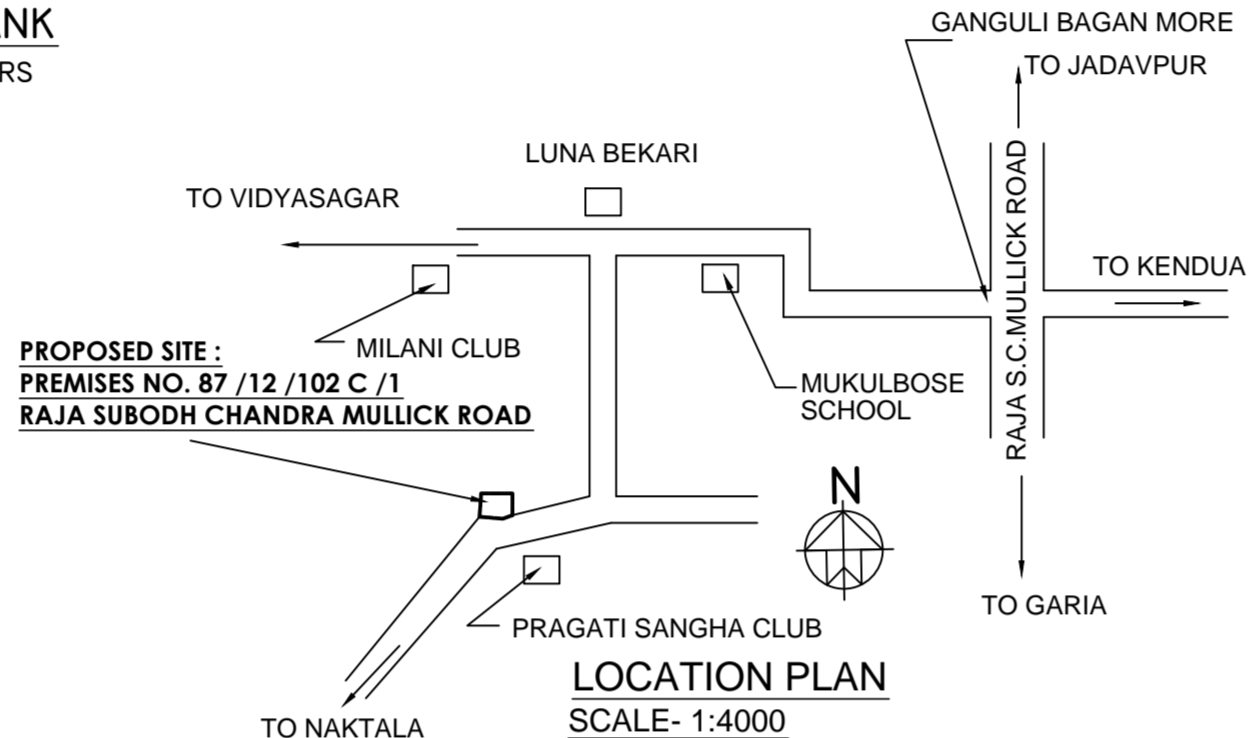
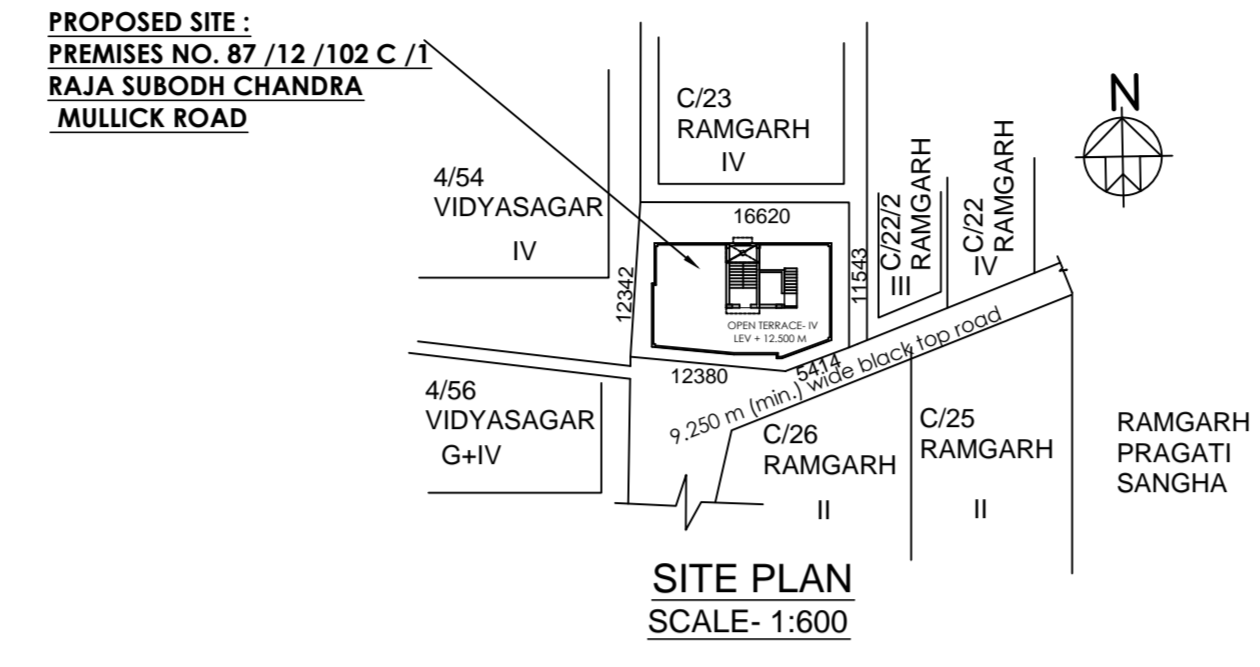

SCHEDULE OF DOORS & WINDOWS

MKD.	SIZE	MKD.	SIZE
D	1000x2100	W1	1500x1350
D1	900x2100	W2	1200x1350
D2	800x2100	W3	500x600
D3	750x2100		

STATEMENT OF PLAN PROPOSAL

A

- ASSESEE NO :- 21-100-08-3954-5
- DETAILS OF MOTHER DEED :- BOOK - 1 VOL NO.-1, PAGE- 21 TO 24 BEING NO.- 06, REG. AT R.O.R.R DEPT. & EX-OFFICE, A.D.S.R. ALIPORE, SOUTH 24 PGS, DATED - 04/01/ 2022.
- DETAILS OF REG. POWER OF ATTORNEY :- BOOK - 1 VOL NO.-1603-2022, PAGE- 330160 TO 330188 BEING NO. - 160309132 REG. AT D.S.R.- III, SOUTH 24 PGS, WEST BENGAL, DATED - 21/06/ 2022
- DETAILS OF REG. BOUNDARY DECLARATION :- BOOK - 1, VOL NO. 1603-2022 PAGE- 497003 TO 497014 BEING NO. - 160314462 REG. AT D.S.R.- III, SOUTH 24 PGS, WEST BENGAL, DATED - 21/09/2022

SPECIFICATIONS :-

- 200 THICK BRICK WALL IN 1:6 MORTAR
- 125 THICK AND 75 THICK BRICK WALLS ARE 1:4 MORTAR
- ALL MATERIALS SHOULD BE AS PER SPECIFICATION OF I.S.I. & B.B. CODES AS SPECIFIED BY THE ENGINEER -IN-CHARGE
- GRADE OF CONCRETE M 20
- GRADE OF STEEL Fe - 500
- BEARING CAPACITY OF SOIL TAKEN INTO ACCOUNT AS PER GEO -TECHNICAL INVESTIGATION REPORT
- PROPORTION OF P.C.C 1:4:8
- PROPORTION OF R.C.C 1:1.5:3

NOTES :-

- ALL DIMENSIONS ARE IN MILLIMETER
- ALL OUTER WALL 200 THICK
- ALL PARTITION WALLS ARE 125 THICK AND 75 THICK
- DEPTH OF SEMI UNDER GROUND WATER RESERVOIR & SEPTIC TANK SHOULD NEVER EXCEED THE DEPTH OF NEAREST BUILDING FOUNDATION
- ALL SHORTS OF PRECAUTIONARY MEASURES SHOULD BE TAKEN DURING CONSTRUCTION

CERTIFICATE OF OWNER :-

I DO HEREBY DECLARE WITH FULL RESPONSIBILITY THAT I SHALL ENGAGE L.B.S. & E.S.E DURING CONSTRUCTION. I SHALL FOLLOW THE INSTRUCTION OF L.B.S. & E.S.E DURING CONSTRUCTION OF THE BUILDING (AS PER B.S. PLAN) K.M.C. AUTHORITY WILL NOT BE RESPONSIBLE FOR STRUCTURAL STABILITY OF THE BUILDING & ADJOINING STRUCTURE. IF ANY SUBMITTED DOCUMENTS ARE FOUND TO BE FAKE, THE K. M. C. AUTHORITY WILL REVOKE THE SANCTION PLAN. THE CONSTRUCTION OF SEMI UNDER GROUND WATER RESERVOIR AND SEPTIC TANK WILL BE UNDERTAKEN UNDER THE GUIDANCE OF L.B.S. & E.S.E. BEFORE STARTING OF BUILDING FOUNDATION WORK. THE PLOT HAS VACANT LAND & THE PREMISES IS OCCUPIED BY THE OWNER & THERE IS NO TENANT. THE PLOT IS IDENTIFIED BY ME DURING DEPARTMENTAL INSPECTION. IF ANY DISCREPANCY ARISES THEN L.B.S. E.S.E & K.M.C. AUTHORITY WILL NOT BE RESPONSIBLE FOR THAT AND K.M.C. WILL HAVE EVERY RIGHT TO REVOKE THE PLAN. THERE IS NO COURT CASE PENDING AGAINST THIS PREMISES.

ABHIJIT GHOSH & SURAJIT PAUL
PARTNERS OF M/S G.P. CONSTRUCTION
CONSTITUTED ATTORNEY OF
SUPRIYO KUMAR DEY & SANJOY KUMAR DEY
NAME OF THE OWNER/C.A.

PLAN OF PROPOSED G+III STORIED RESIDENTIAL BUILDING U/S 393 A OF K.M.C ACT 1980 AND BUILDING RULE 2009 AT PREMISES NO. 87 /12 /102 C /1, RAJA SUBODH CHANDRA MULICK ROAD KOLKATA-700047, WARD NO-100, BR.- X P.S.- NETAJI NAGAR.

HEIGHT OF THE BUILDING - 12.500 M

PLAN CASE NO: 2022100254
B.P. NO.: 2022100226
DATED: 03-FEB-2023
VALID FOR 5 YEARS FROM DATE OF SANCTION.

ASSISTANT ENGINEER(C)/Bldg/BR-X [K.M.C.]

B

- AREA OF LAND :- AS PER DEED & ASSESSMENT BOOK :- 3 K. - 04 CH. - 00 SFT. = 217.391 Sqm. AS PER BOUNDARY DECLARATION :- 3 K. - 03 CH.- 44 SFT= 217.311 Sqm.
- ROAD WIDTH :- 9.250 M (MINIMUM)
- PERMISSIBLE GROUND COVERAGE = 129.130 SQM. = 59.422 %
- PROPOSED GROUND COVERAGE = 122.611 SQM. = 56.422 %
- PROPOSED AREA :-

FLOOR	TOTAL AREA (SQM.)	CUTOUT AREA (SQM.)	COVERED AREA (SQM.)	STAIR & STAIR LOBBY (SQM.)	LIFT LOBBY (SQM.)	NET FLOOR AREA (SQM.)
GR. FL.	122.611 Sqm.		122.611 Sqm.	10.34 Sqm.	2.16 Sqm.	110.11 Sqm.
1st. FL.	122.611 Sqm.	1.54 Sqm.	121.071 Sqm.	10.34 Sqm.	2.26 Sqm.	108.47 Sqm.
2nd. FL.	122.611 Sqm.	1.54 Sqm.	121.071 Sqm.	10.34 Sqm.	2.26 Sqm.	108.47 Sqm.
3rd. FL.	122.611 Sqm.	1.54 Sqm.	121.071 Sqm.	10.34 Sqm.	2.26 Sqm.	108.47 Sqm.
TOTAL.	490.444 Sqm.	4.62 Sqm.	485.824 Sqm.	41.36 Sqm.	8.94 Sqm.	435.53 Sqm.

6A. TOTAL RESIDENTIAL AREA :- 472.295 Sqm.
6B. MERCANTILE COVERED AREA :- 13.529 Sqm.
MERCANTILE CARPET AREA :- 12.026 Sqm.

7. PARKING CALCULATION.

FLAT MKD.	COVERED AREA	SHARE OF COM. AREA	BUILT - UP AREA	TENEMENT NUMBER	REQUIRED PARKING
A	54.137 Sqm.	11.20 Sqm.	65.34 Sqm.	3	1
B	53.205 Sqm.	11.01 Sqm.	64.22 Sqm.	3	

- Nos. OF PARKING REQUIRED = 1
- Nos. OF PARKING PROVIDED = 2
- AREA OF PARKING = 83.62 Sqm
- PERMISSIBLE F.A.R - 2.25
- PROPOSED F.A.R - (435.53- 25.00) / 217.311 = 1.889 < 2.25
- STAIR COVER AREA = 13.648 Sqm.
- O. H. WATER TANK AREA = 4.108 Sqm.
- DEPTH OF BUILDING = 9.172 m.
- HEIGHT OF THE BUILDING = 12.500 m.
- COMMON AREA = 66.645 Sqm.
- TERRACE AREA = 122.611 Sqm.
- AREA OF TREE COVER = 3.996 Sqm.
- AREA OF CUP BOARD = 7.389 Sqm.
- ADDITIONAL AREA FOR FEES = 30.842 Sqm.
- TOTAL FLOOR AREA [INCLUDING EXEMPTED AREA] = 516.666 Sqm

L. B. S. DECLARATION :-

CERTIFIED WITH FULL RESPONSIBILITY THAT THE BUILDING PLAN HAS BEEN DRAWN AS PER PROVISION OF K.M.C. BUILDING RULES, 2009 AS AMENDED FROM TIME TO TIME & THAT THE SITE CONDITIONS INCLUDING THE ADJOINING ROAD CONFORM WITH THE PLAN, WHICH HAS BEEN MEASURED AND VERIFIED BY ME. IT IS A BUILDABLE SITE NOT A TANK OR FILLED UP TANK. THE LAND IS DEMARCATED BY BOUNDARY WALL. THE PREMISES IS OCCUPIED BY THE OWNER & THERE IS NO TENANT.

- THE CONSTRUCTION OF SEMI U. G. WATER TANK AND SEPTIC TANK WILL BE COMPLETED BEFORE STARTING OF BUILDING FOUNDATION WORK
- ROAD WIDTH - 9.250 M. (MIN.) WIDE BLACK TOP ROAD ON THE SOUTHERN SIDE.

KUNTAL PAUL
L.B.S. NO. 1400, CLASS - I
NAME OF L.B.S

E. S. E. DECLARATION :-

THE STRUCTURAL DESIGN OF BOTH FOUNDATION AND SUPER STRUCTURE OF THE BUILDING HAVE BEEN MADE BY ME CONSIDERING ALL POSSIBLE LOADS INCLUDING THE SEISMIC LOAD AS PER NATIONAL BUILDING CODE OF INDIA CERTIFY THAT IT IS SAFE AND STABLE IN ALL RESPECT. SOIL TESTING REPORT HAS BEEN DONE BY " M/S TECHNOSOIL", GORKHARA, ARUNACHAL, SONARPUR, KOLKATA-700150 SIGNED BY MR. KALLOL KUMAR GHOSHAL [G.T.E NO- II /14]. THE RECOMMENDATION OF SOIL REPORT HAS BEEN CONSIDERING DURING STRUCTURAL CALCULATION.

SUMAN KR. MITRA
E.S.E. NO. 602, CLASS - II
NAME OF THE E.S.E. [K.M.C.]

DECLARATION OF GEO-TECHNICAL ENGINEER

UNDERSIGNED HAS INSPECTED THE SITE AND CARRIED OUT SOIL INVESTIGATION THEREIN. IT IS CERTIFIED THAT THE EXISTING SOIL OF THE SITE IS ABLE TO CARRY THE LOAD COMING FROM THE PROPOSED CONSTRUCTION AND THE FOUNDATION SYSTEM PROPOSED THEREIN IS SAFE AND STABLE IN ALL RESPECT FROM GEO-TECHNICAL POINT OF VIEW.

KALLOL KUMAR GHOSHAL [G.T.E/II /14]
NAME OF THE GEO-TECHNICAL ENGINEER [K.M.C.]

SCALE :- 1:50, 1:100, 1:150, 1:600, 1:4000 (UNLESS OTHERWISE NOTED)

DRAWN BY :- KUNTAL PAUL
KUNTAL PAUL & ASSOCIATES
PLANNER, DESIGNER, ESTIMATOR, LAND SURVEYOR

